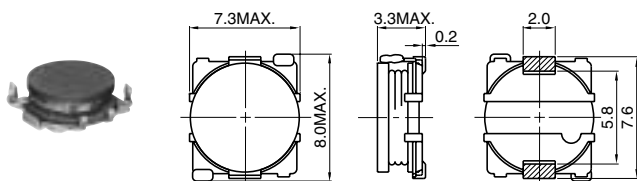
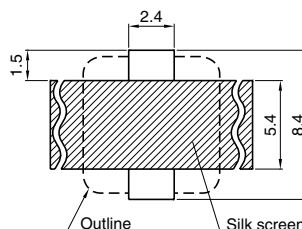

**UNSHIELDED TYPE**

# CDH73

**Outline**

SMT type power inductors whereby the electrode is attached to the ferrite core directly.

**Dimensions (mm)**

**LAND PATTERNS(mm)**

**CONSTRUCTION**

 (10 $\mu$ H – 220 $\mu$ H)

In order to prevent short-circuiting, a silk screen is recommended.

**◆ TYPE CDH73**

Parts No.	Inductance	D.C.R. ( $\Omega$ ) (Max) Typical / Rated D. C. Current (A)	Parts No.	Inductance	D.C.R. ( $\Omega$ ) (Max) Typical / Rated D. C. Current (A)
2R2	2.2 $\mu$ H		390	39 $\mu$ H	0.28 (0.21) / 0.59
2R7	2.7 $\mu$ H		470	47 $\mu$ H	0.35 (0.27) / 0.56
3R3	3.3 $\mu$ H		560	56 $\mu$ H	0.40 (0.31) / 0.51
3R9	3.9 $\mu$ H		680	68 $\mu$ H	0.51 (0.39) / 0.47
4R7	4.7 $\mu$ H		820	82 $\mu$ H	0.60 (0.46) / 0.41
5R6	5.6 $\mu$ H		101	100 $\mu$ H	0.70 (0.54) / 0.37
6R8	6.8 $\mu$ H		121	120 $\mu$ H	0.89 (0.69) / 0.35
8R2	8.2 $\mu$ H		151	150 $\mu$ H	1.04 (0.80) / 0.31
100	10 $\mu$ H	77m (59m) / 1.20	181	180 $\mu$ H	1.22 (0.94) / 0.28
120	12 $\mu$ H	92m (71m) / 1.05	221	220 $\mu$ H	1.63 (1.30) / 0.26
150	15 $\mu$ H	0.11 (87m) / 1.00	271	270 $\mu$ H	
180	18 $\mu$ H	0.13 (0.10) / 0.90	331	330 $\mu$ H	
220	22 $\mu$ H	0.18 (0.14) / 0.81	391	390 $\mu$ H	
270	27 $\mu$ H	0.21 (0.16) / 0.75	471	470 $\mu$ H	
330	33 $\mu$ H	0.24 (0.19) / 0.66			

Measuring Freq. (L)

CDH73 1kHz

Tolerance of Inductance

 CDH73 10 $\mu$ H – 12 $\mu$ H  $\pm$  20% (M), 15 $\mu$ H – 27 $\mu$ H  $\pm$  15% (L), 33 $\mu$ H – 220 $\mu$ H  $\pm$  10% (K)

Rated D.C. Current

 This indicates the value of current when the inductance is 10% lower than its initial value at D.C. superimposition or D.C. current when at  $t=40^{\circ}\text{C}$ , whichever is lower. ( $T_a=20^{\circ}\text{C}$ )

**Sales Contact**
**North America**  
 1701 Golf Road, Tower 3  
 Suite 400, Rolling  
 Meadows, IL 60008, USA  
 Tel: (1) 847 545-6700  
 Fax: (1) 847 545-6720

**Japan**  
 Nihonbashi- ingyocho  
 2-Chome, Chuo-ku,  
 Tokyo, Japan  
 Tel: (81) 03 3667-3301  
 Fax: (81) 03 3667-3456

**Hong Kong**  
 14/F, Eastern Centre,  
 1065 King's Road, Quarry  
 Road, Hong Kong  
 Tel: (852) 2880-6688  
 Fax: (852) 2880-9596

**Taiwan**  
 No. 171, Futech Street,  
 Hsin-I, Taipei, Taiwan,  
 ROC  
 Tel: (886) 2 2726-2177  
 Fax: (886) 2 2728-2726

**Singapore**  
 996 Bendemeer  
 Road #04-05 to 06  
 Singapore 339944  
 Tel: (65) 2963-388  
 Fax: (65) 2963-390

**Europe**  
 Chaussee de Tervuren113A,  
 1160 Brussels  
 Belgium  
 Email:  
 europe.sales@hk.sumida.com